

WAVE ENERGY CONVERTOR

Each element produces energy using wave motion. The plate remains stationary. At the first step the spring is fully elongated and the hydraulic cylinder is in a neutral position. When the wave breaks on this structure the spring is compressed and as result the hydraulic cylinder extends and moves the float through the floating force. Afterwards the buoy moves down with the motion of wave, so the hydraulic cylinder is fully compressed and the springs push back on hydraulic cylinder. This movement causes from the buoy also move the "artificial plant" to imitate the flow of the water with an astonishing effect.

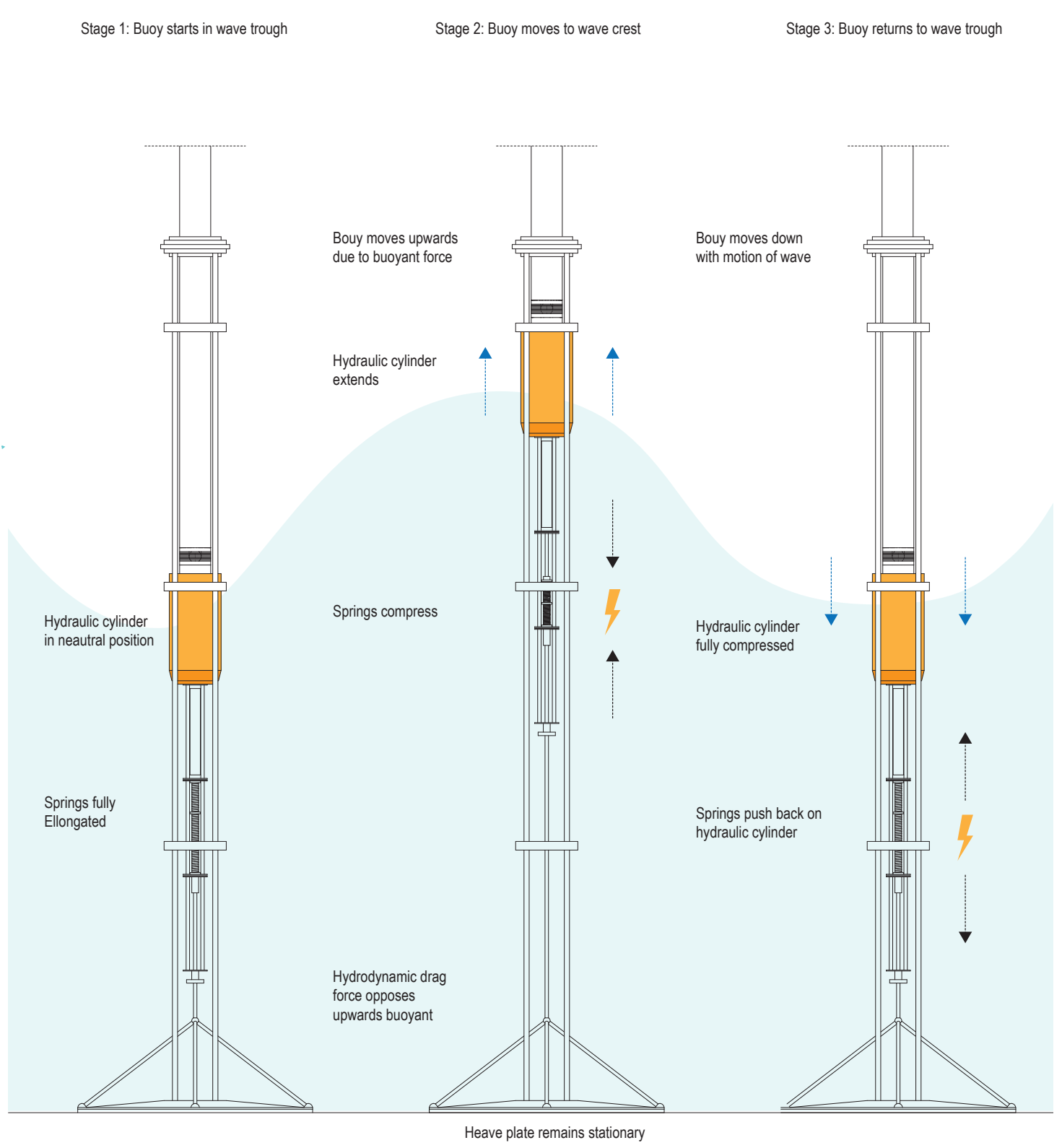

CHAINSWORD
seafront water park

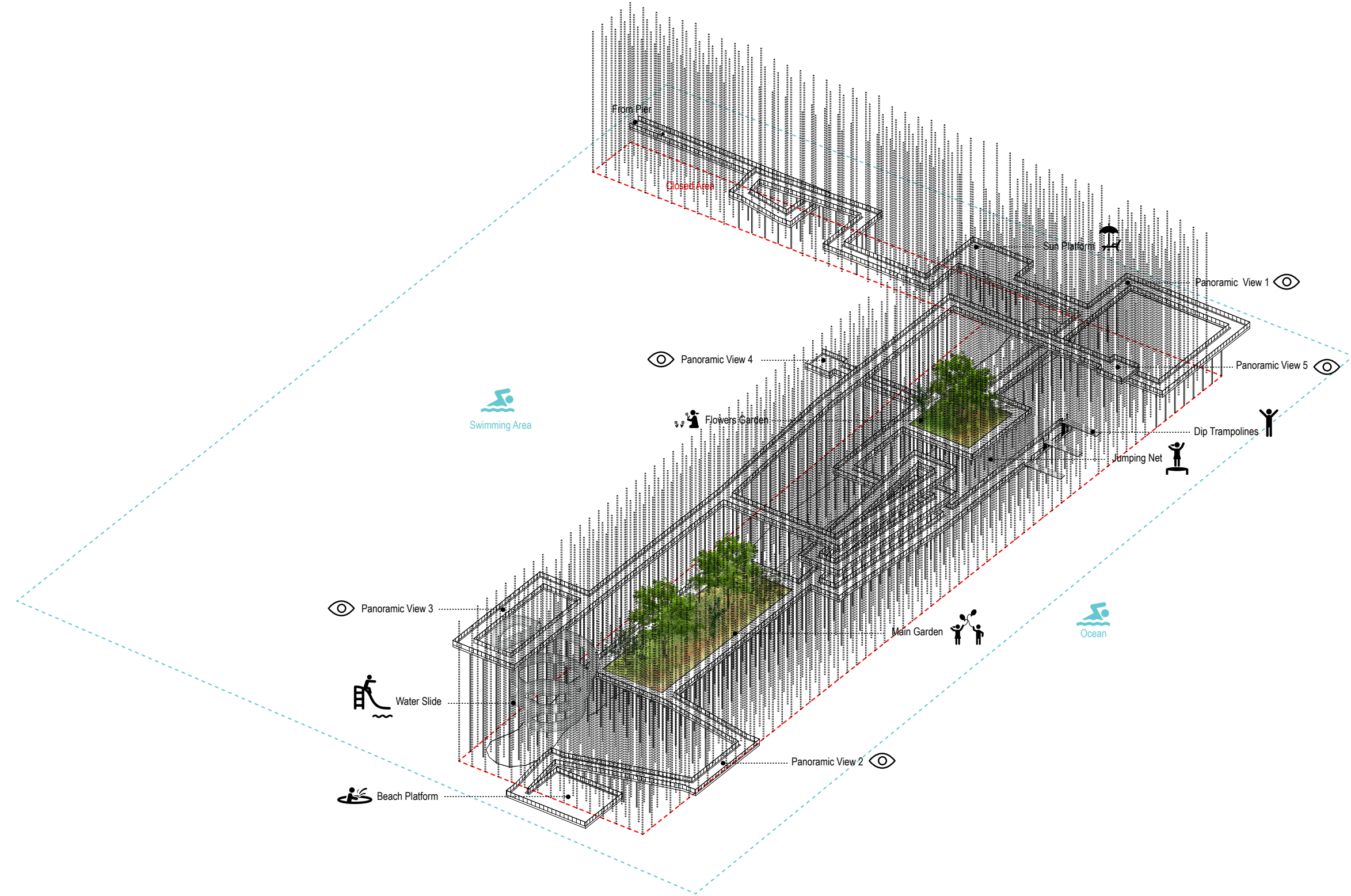