

ENERGY BALL

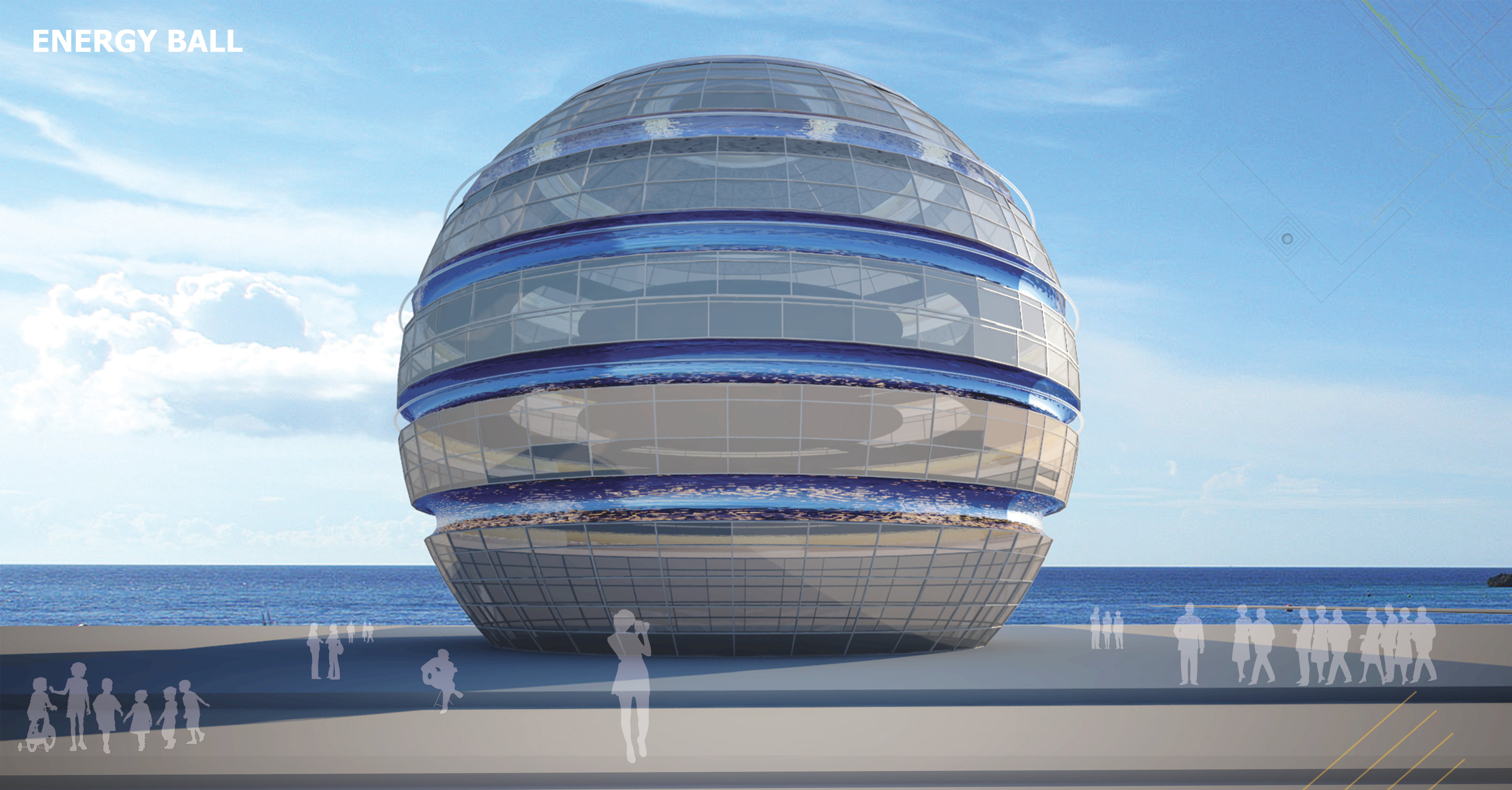

FLOOR LAYOUTS

CENTRAL PART IS FOR SERVICE SPACES, WHERE ALL THE MECHANICAL AND ELECTRICAL EQUIPMENTS ARE LOCATED AND THE SPACE NEAR CURTAIN GLAZING IS DEDICATED

TOTAL DIAMETER OF CIRCLE IS 40 METRE AND VIEW PLATFORM IS 3.5 TO 4 METRE WIDE. AND TOTAL HEIGHT IS 38 METRE HIGH. THESE DIAMETER AND HEIGHT CAN BE VARIES AS PER REQUIRE-

THE PARABOLIC TROUGH PANELS ARE ARRANGED ALONG THIS CURVE FORM, TO GET MAXIMUM SOLAR RADIATION.

THE PHOTO VOLTIC PANELS ARE PROVIDED ALONG THE TOP SURFACE OF THE FORM.

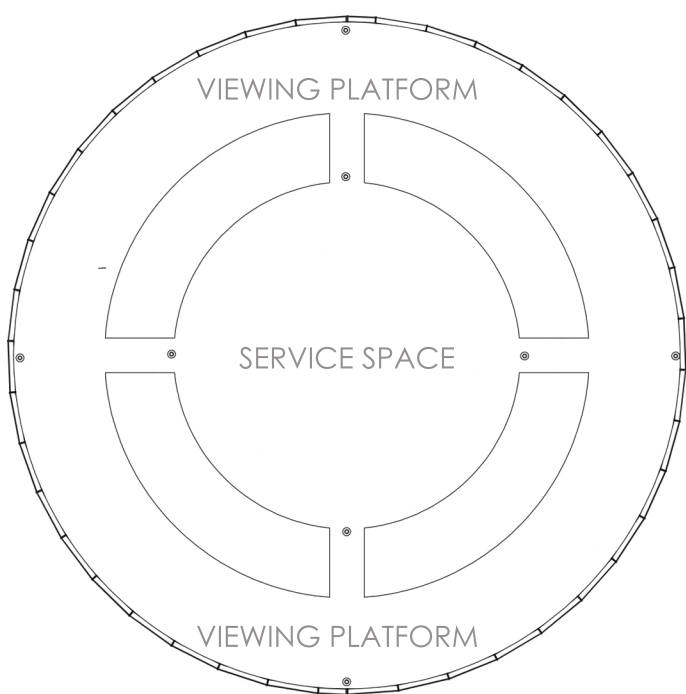

VIEW LEVEL 01

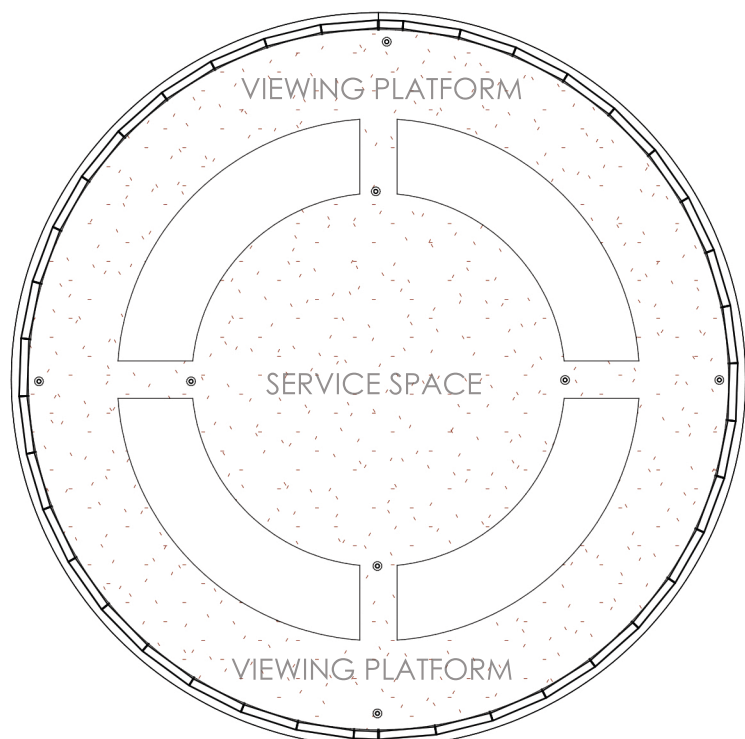

VIEW LEVEL 02

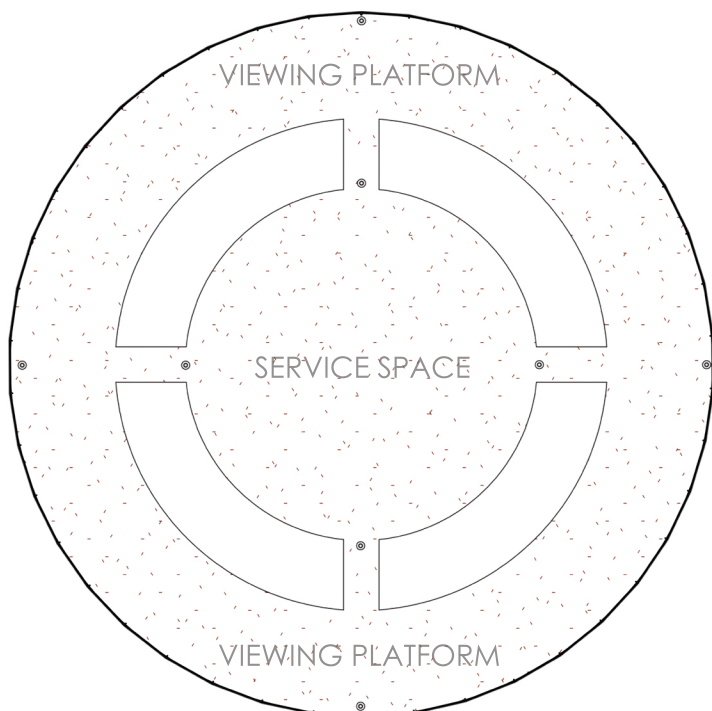

VIEW LEVEL 03

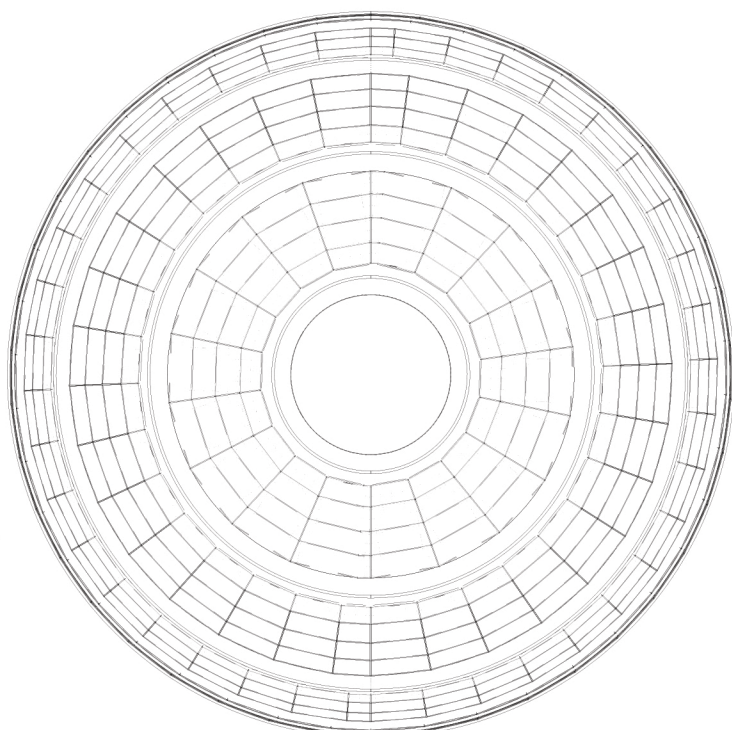

TOP LEVEL

