

VIEW 2
BEFORE SUNSET

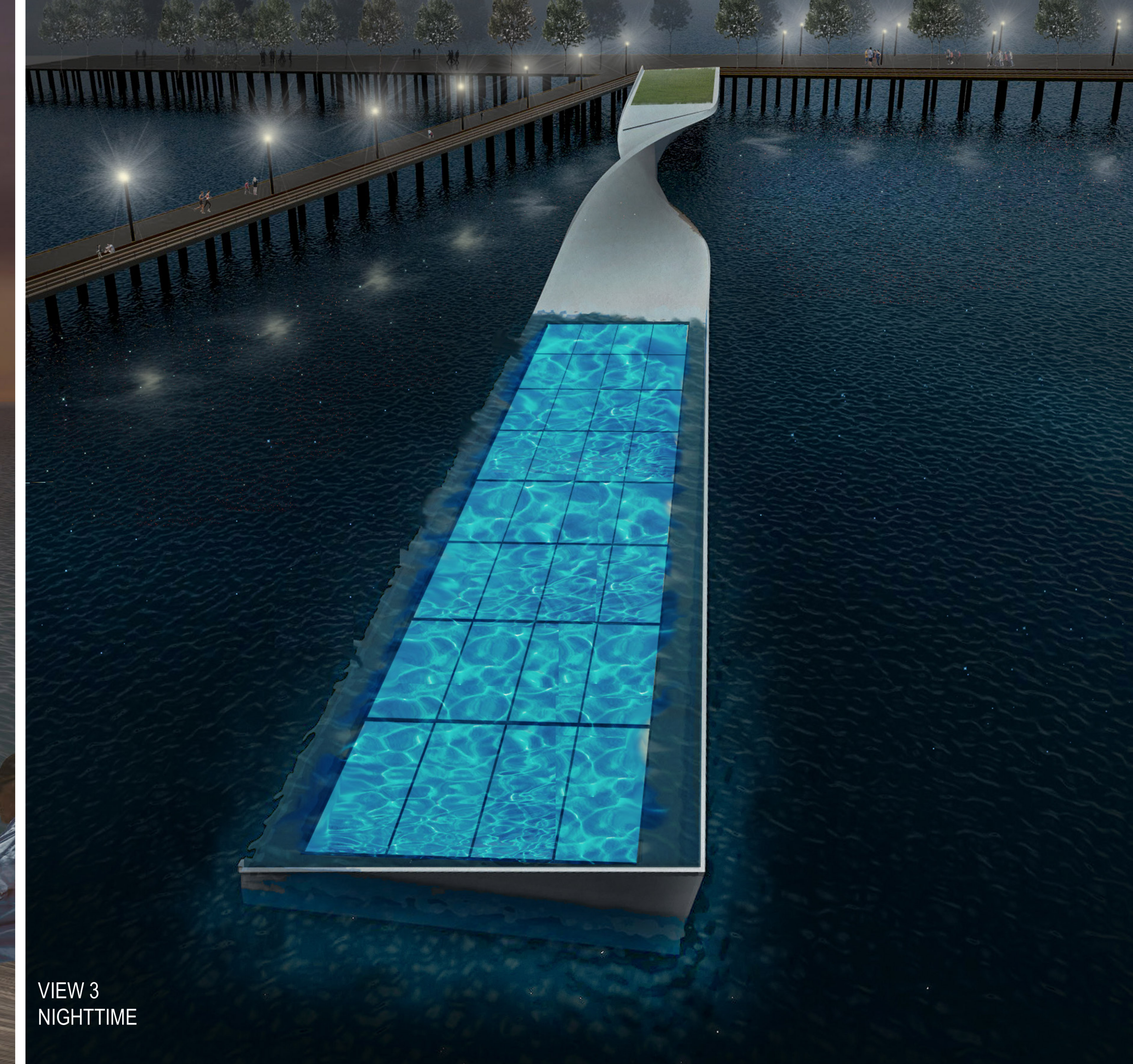

VIEW 3
NIGHTTIME

SECTION

ELECTRIC GENERATION

DETAIL A: Buoyant Balloon

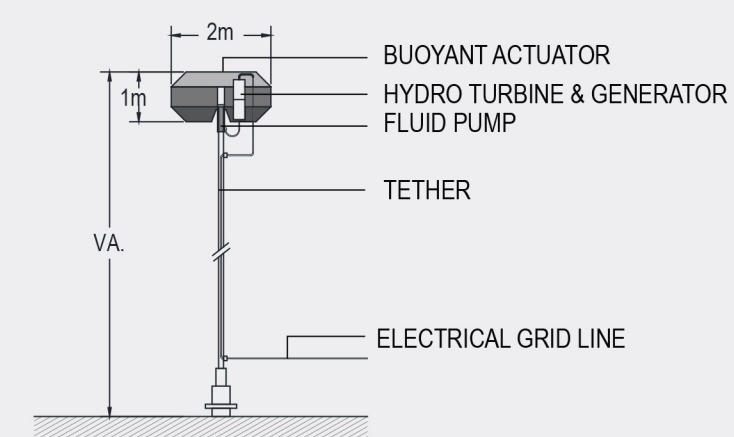

The fluid pump and the hydro turbine and generator inside the buoyant actuator convert waves' movement into electricity. The generated electricity is transmitted to the city through the tether and the electrical grid line. Partly, it is reserved in the battery under the seawater bowl to be used for desalination.

Production Capacity:

Annual generation of one buoyant balloon: 100kW
Number of buoyant balloons: 136

Total annual generation:
 $100\text{kW} \times 136 = 13.6\text{MW}$
(which supports 1,880 homes)

DESALINATION

DETAIL B: Seawater Bowl

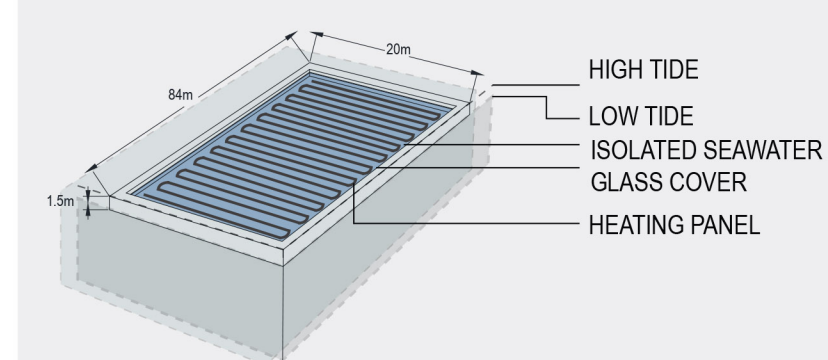

DETAIL C: Steam Path

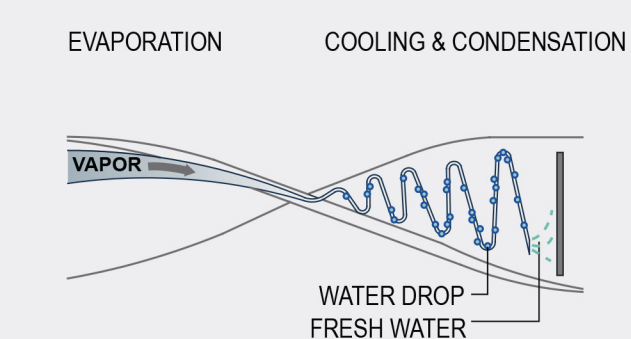

Production Capacity:

Seawater bowl capacity: 164 tons
Number of high tides a day: 2
Time period of moderate or heavy rain in a year: 10%

Annual desalination capacity:
 $164 \text{ tons} \times 2 \times 365 \times 0.9 = 108,000 \text{ tons}$
(which covers 295 homes)

+ Annual rainfall on the lawn area: 540 tons

